

**Myes Standish State Forest Notes:**

Flood Zone: FEMA Zone X, MASSGIS.

Point	Description	Proposed Tasks
A	Industrial Wastewater Holding Tank (IWHHT), double-wall, Fiberglass Reinforced Plastic (FRP), Nominal capacity 12,000 gallons, with Deadmen to resist hydrostatic uplift for empty and fully submerged Tank.	Invert at IWHHT to match existing pipe size and invert. Connection to existing piping shall be by sleeve coupling or flange adapter.
B	Invert at IWHHT to match existing pipe size and invert. Connection to existing piping shall be by sleeve coupling or flange adapter.	Pump, clean, and remove existing heavy duty concrete septic tank. Dispose of property off-site, in accordance of Local and State Regulations.
C	Alarm System Control Panel - Securable weather proof cabinet, either pad-, or pole-mounted.	-Local audio & visual level alarms.
D	-Intermittent leak detection alarm. -Level and leak detection alarms transmitted to manned station via cellular connection. Contact number to be provided by owner. -System to be battery operated with solar recharging.	Saw-cut and patch existing pavement for new piping, if necessary. Saw-cut and repair any pavement damaged during construction. See Detail for repair.
E	Saw-cut and repair any pavement damaged during construction. See Detail for repair.	Label IWHHT MH cover or provide a sign adjacent to the IWHHT stating "Non-Hazardous Industrial Wastewater."
F	Label IWHHT MH cover or provide a sign adjacent to the IWHHT stating "Non-Hazardous Industrial Wastewater."	Disturbed surface to be covered with 3 inches of loam and seeded.
G	Disturbed surface to be covered with 3 inches of loam and seeded.	Limit of work - Siltation Fence & Hay Bales
H	Limit of work - Siltation Fence & Hay Bales	Four existing leaching pits with C.I. Frame & covers and D-Box to be pumped & abandoned by filling with sand.
I	Four existing leaching pits with C.I. Frame & covers and D-Box to be pumped & abandoned by filling with sand.	

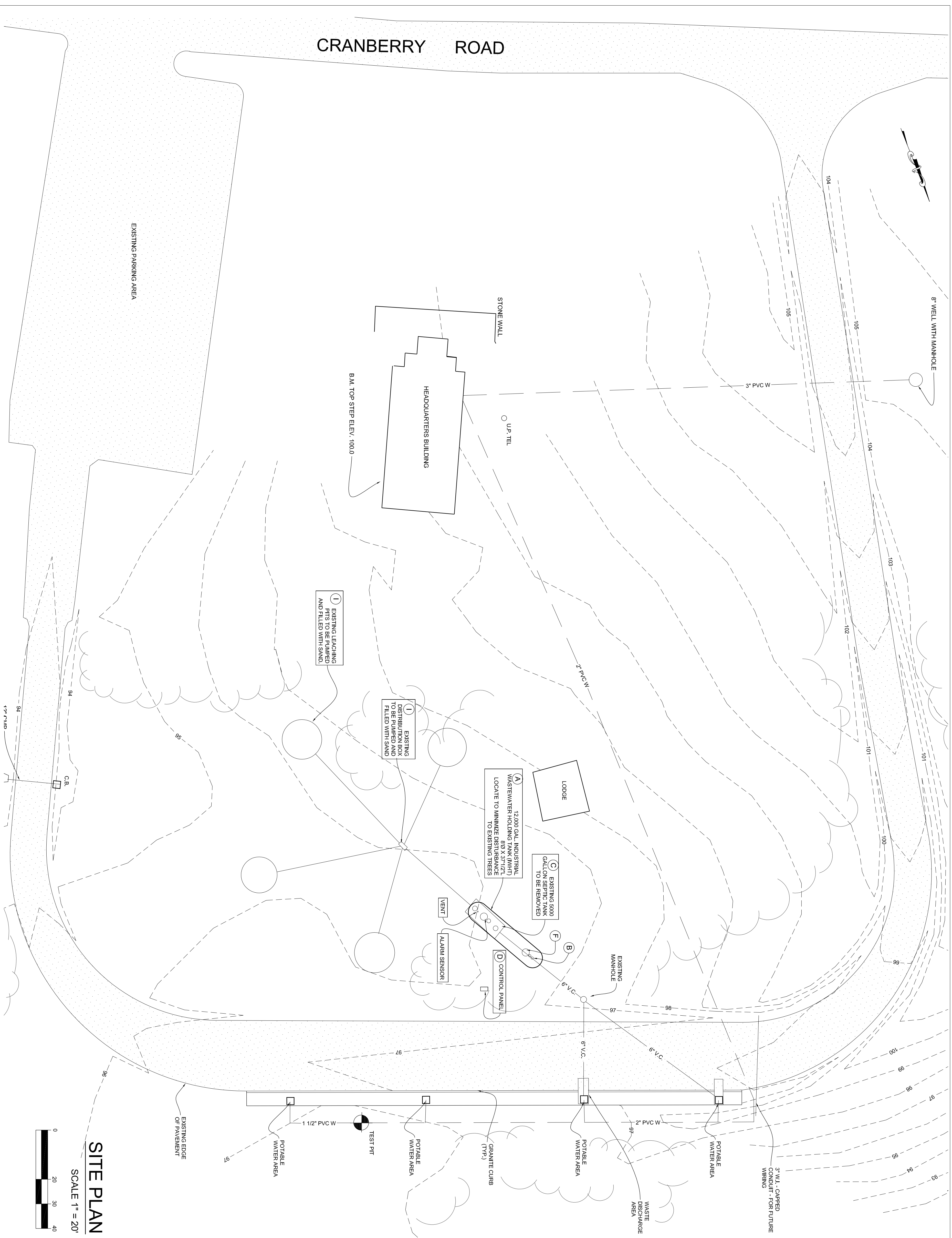

**SITE PLAN**  
SCALE 1" = 20'

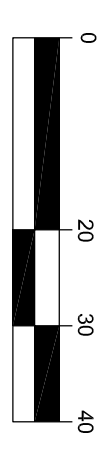

**LEGEND**

---	EXISTING CONTOUR
---	EXISTING UTILITIES (APPROX. LOCATION)
⊙	SOIL TEST LOCATION 7/23/70

**TEST PIT LOG**

0"	LOAM
3"	MEDIUM TO FINE SAND
70"	

**NOTE:**  
SITE PLAN IS FOR INDUSTRIAL WASTEWATER HOLDING TANK (IWHHT) ONLY, AND SHOULD NOT BE CONSIDERED A PROPERTY LINE SURVEY OR CERTIFIED PLOT PLAN. PLAN IS BASED ON TRAILER WASTE STATION SITE PLAN BY CAMP DRESSER AND MCKEE CONSULTING ENGINEERS OF BOSTON, MA, DATED AUGUST 1968.

Myes Standish State Forest  
Cranberry Road, P.O. Box 86  
South Carver, MA, 02586  
Contact: Bob Mackenzie (508) 886-9245

**CGE Engineering, Inc.**  
Civil ♦ Geotechnical ♦ Environmental

CONTACT PERSON: RONALD F. BUKOSKI, P.E., L.S.P.  
ADDRESS: 21 HILLTOP DRIVE, P.O. BOX 456  
SAGAMORE, MASSACHUSETTS 02561  
TELEPHONE: (508) 833-2250

**Maguire Group Inc.**  
Architects/Engineers/Planners

33 Commercial Street, Suite 1  
Forthborough, MA 02035

Proj. Mgr.: W.J.N.  
Designed: RFB  
Drawn: JSB  
Checked: JSB  
Scale: 05/01/07  
Date:

Recreational Wastewater Holding Tanks  
Southeast Region

**MYLES STANDISH STATE FOREST  
TRAILER WASTE STATION**  
CRANBERRY RD., S. CARVER, MA

Proj. No. 18235  
Dwg. No. S-4

THIS LINE IS ONE INCH LONG WHEN PLOTTED AT FULL SCALE ON A 24" X 36" DRAWING