

**Massasoit State Park Notes**

Flood Zone: FEMA Zone X, MassGIS.

Point	Description
A	Industrial Wastewater Holding Tank (IWHHT), double-wall, Fiberglass Reinforced Plastic (FRP), Nominal capacity 4,000 gallons, with Deadmen to resist hydrostatic uplift for empty and fully submerged Tank.
B	Invert at IWHHT to match existing pipe size and invert. Connection to existing piping shall be by sleeve coupling or flange adapter.
C	Pump, clean, and remove existing heavy duty concrete septic tank, siphon chamber, and D-Box. Dispose of properly off-site. In accordance of Local and State Regulations.
D	Alarm System Control Panel - Securable weather proof cabinet, either pad- or pole-mounted. -High level alarms for IWHHT - set at 75 & 90% capacity based on Manufacturer's calibration chart. -Local audio & visual level alarms. Interstitial leak detection alarm. -Level and leak detection alarms transmitted to manned station via cellular connection. Contact number to be provided by owner. -System to be battery operated with solar recharging.
E	Saw-cut and patch existing pavement for new piping. If necessary, Saw-cut and repair any pavement damaged during construction. See Detail for repair.
F	Label IWHHT MH cover or provide a sign adjacent to the IWHHT stating "Non-Hazardous Industrial Wastewater."
G	Disturbed surface to be covered with 3 inches of loam and seeded.
H	Limit of work - Siltation Fence & Hay Bales

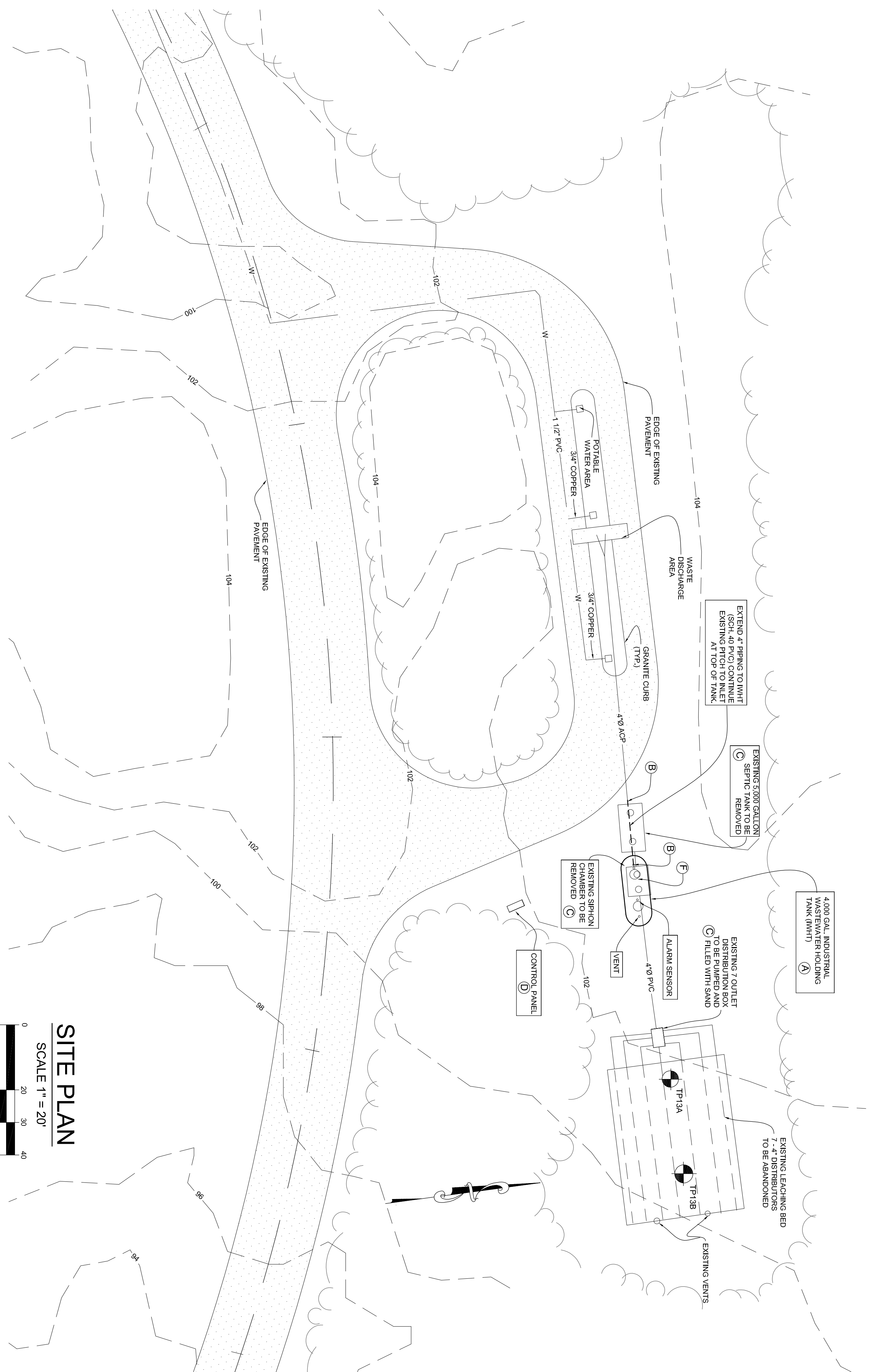

**SITE PLAN**  
SCALE 1" = 20'

**NOTE:**  
SITE PLAN IS FOR INDUSTRIAL WASTEWATER HOLDING TANK (IWHHT) ONLY, AND SHOULD NOT BE CONSIDERED A PROPERTY LINE SURVEY OR CERTIFIED PLAT PLAN. PLANS BASED ON SITE DEVELOPMENT PLAN BY CHAS. T. MAIN INC. OF BOSTON, MA, DATED JULY 10 1997.

Massasoit State Park  
1361 Middleboro Avenue  
East Taunton, MA 02718  
Contact: Steve Radel (508) 822-7405

**LEGEND**

- 50 - - - - - EXISTING CONTOUR
- - - - - EXISTING UTILITIES (APPROX. LOCATION)
- ⊙ SOL. TEST LOCATION 772370

<p><b>THIS LINE IS ONE INCH LONG WHEN PLOTTED AT FULL SCALE ON A 24" X 36" DRAWING</b></p>	
<p>N:\Projects\17380\CAD_Standard\LOGOS\ldcf_logo1.png</p>	
<p><b>Maguire Group Inc.</b> Architects/Engineers/Planners 33 Commercial Street, Suite 1 Foxborough, MA 02035</p>	
<p><b>CGE Engineering, Inc.</b> Civil ♦ Geotechnical ♦ Environmental CONTACT PERSON: RONALD F. BUKOSKI, P.E., L.S.P. ADDRESS: 21 HILLTOP DRIVE, P.O. BOX 456 SAGAMORE, MASSACHUSETTS 02561 TELEPHONE: (508) 833-2250</p>	
<b>MARK</b>	<b>DATE</b>
<b>DESCRIPTION</b>	
<b>Proj. Mgr.:</b> W.J.N.	<b>Designed:</b> R.B.
<b>Drawn:</b> JSB	<b>Checked:</b>
<b>Date:</b> 05/01/07	<b>Scale:</b>
<b>CAD FILE:</b> 1: 070212\MASSASOIT	
<p>Recreational Wastewater Holding Tanks Southeast Region</p>	
<p>MASSASOIT STATE PARK TRAILER WASTE STATION 1361 MIDDLEBORO AVENUE, EAST TAUNTON, MA</p>	
<b>Proj. No.</b> 18235	<b>Dwg. No.</b> S-3